

CARSON

TWO PIECE DUAL FLUSH HIGH EFFICIENCY TOILET
TOILETTE DEUX PIÈCES HAUTE EFFICACITÉ

- **4720BPW** Lined Tank / Réservoir isolé
- **4720BPWU** Unlined Tank / Réservoir non-isolé

4.8LPF / 1.28GPF OR (OU) 1.28GPF / 0.8GPF



ILLUSTRATED PARTS LIST | LISTE DE PIÈCES ILLUSTRÉE

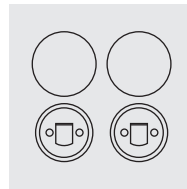
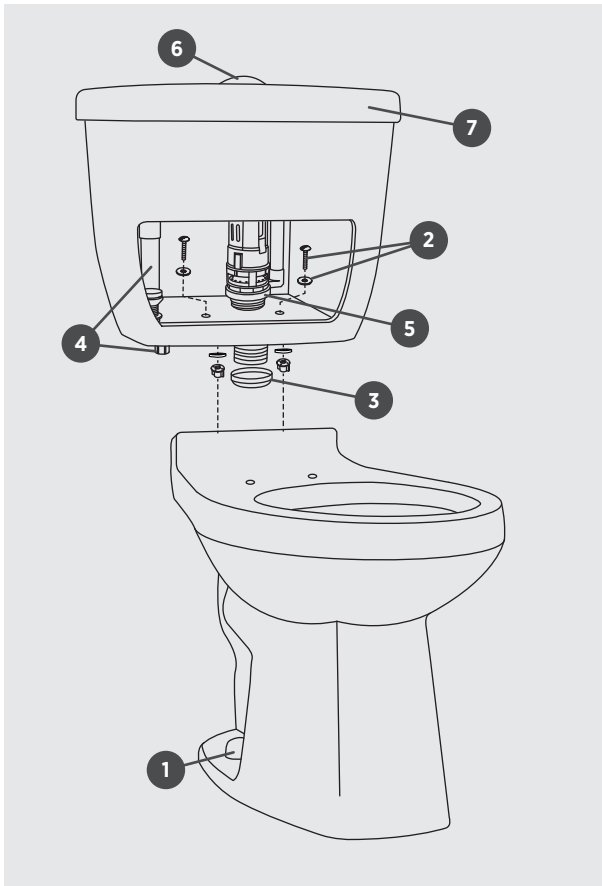

1 |
PB-BOLT CAP SW-ZH090
BOLT CAPS
BOUCHONS

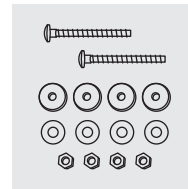

2 |
PB-CONTRAC TANK HW
TANK HARDWARE
MATÉRIEL DE RÉSERVOIR

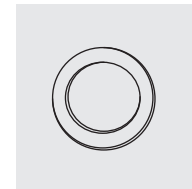

3 |
PB-TOILET GASKET 3IN
GASKET
JOINT

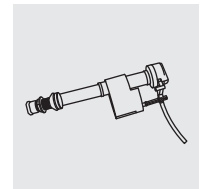

4 |
PB-FILLV-RT-A1250
FILL VALVE
ROBINET DE REMPLISSAGE

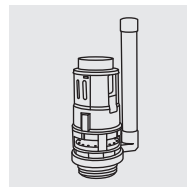

5 |
PB-FLUSHV-RT-A241703
FLUSH VALVE
ROBINET DE CHASSE

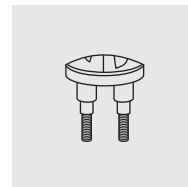

6 |
PBC-PUSHLEVERA36131W
PUSH BUTTON
BOUTON-POUSSOIR

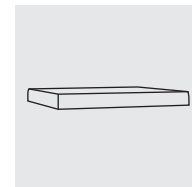

7 |
PB-4720BFZ-SW T LID
TANK LID
COUVERCLE DU RÉSERVOIR

*Toilet seat not included